

# SUB SERIES

HYDRAULIC AUTOMATION FOR SWING GATES



Opens the future



• **A MODEL FOR EVERY NEED.**

→ Several versions available: irreversible with hydraulic locking (for holding when closed and open) and reversible (with use of an electric lock).

• **SAFE USE.**

→ Antisquashing protection guaranteed by two adjustable bypass valves.

• **SIMPLER INSTALLATION.**

→ The special foundation case makes it possible to remove the operator without taking off the gate leaf.

CODE	DESCRIPTION	VOLTAGE	LEAF WEIGHT	LEAF LENGTH
P930026 00001	SUB SC RIGHT	230 V	up to 8000 N (~800 kg)	up to 1.80 m
P930026 00002	SUB SC LEFT	230 V	up to 8000 N (~800 kg)	up to 1.80 m
P930012 00005	SUB R SC RIGHT	230 V	up to 8000 N (~800 kg)	up to 1.80 m
P930012 00006	SUB R SC LEFT	230 V	up to 8000 N (~800 kg)	up to 1.80 m
P930010 00005	SUB G SC RIGHT	230 V	up to 8000 N (~800 kg)	up to 1.80 m
P930010 00006	SUB G SC LEFT	230 V	up to 8000 N (~800 kg)	up to 1.80 m
P930013 00007	SUB ER SC RIGHT	230 V	up to 8000 N (~800 kg)	up to 2.50 m
P930013 00008	SUB ER SC LEFT	230 V	up to 8000 N (~800 kg)	up to 2.50 m
P930014 00005	SUB EL SC RIGHT	230 V	up to 8000 N (~800 kg)	up to 3.50 m
P930014 00006	SUB EL SC LEFT	230 V	up to 8000 N (~800 kg)	up to 3.50 m

## TECHNICAL FEATURES

	SUB SC	SUB R SC	SUB G SC
CONTROL PANEL	ALCOR N (suggested)	ALCOR N (suggested)	ALCOR N (suggested)
REVERSIBLE/IRREVERSIBLE OPERATOR	irreversible	irreversible	irreversible
POWER SUPPLY	230 V- ± 10%, 50 Hz single-phase	230 V- ± 10%, 50 Hz single-phase	230 V- ± 10%, 50 Hz single-phase
ABSORBED POWER	250 W	250 W	250 W
THERMAL PROTECTION	integrated	integrated	integrated
OPENING ANGLE	130°	130°	180°
OPENING OR CLOSING TIME	24 s	14 s + slowdown	33 s
SLOWDOWN	-	opening/closing	-
IMPACT REACTION	hydraulic clutch	hydraulic clutch	hydraulic clutch
TYPE OF LOCK	hydraulic opening/closing	hydraulic opening/closing	hydraulic opening/closing
MANUAL RELEASE	release key	release key	release key
OPERATING CYCLE	very intensive use	very intensive use	very intensive use
ENVIRONMENTAL CONDITIONS	from -10°C to + 60°C	from -10°C to + 60°C	from -10°C to + 60°C
DEGREE OF PROTECTION	IP67	IP67	IP67
OPERATOR WEIGHT	220 N (~22 kg)	220 N (~22 kg)	240 N (~24 kg)
DIMENSIONS	see drawing	see drawing	see drawing
	<b>SUB ER SC</b>	<b>SUB EL SC</b>	
CONTROL PANEL	ALCOR N (suggested)	ALCOR N (suggested)	
REVERSIBLE/IRREVERSIBLE OPERATOR	reversible	reversible	
POWER SUPPLY	230 V- ± 10%, 50 Hz single-phase	230 V- ± 10%, 50 Hz single-phase	
ABSORBED POWER	250 W	250 W	
THERMAL PROTECTION	integrated	integrated	
OPENING ANGLE	130°	130°	
OPENING OR CLOSING TIME	14 s + slowdown	33 s	
SLOWDOWN	opening/closing	-	
IMPACT REACTION	hydraulic clutch	hydraulic clutch	
TYPE OF LOCK	electric lock	electric lock	
MANUAL RELEASE	reversible	reversible	
OPERATING CYCLE	very intensive use	very intensive use	
ENVIRONMENTAL CONDITIONS	from -10°C to + 60°C	from -10°C to + 60°C	
DEGREE OF PROTECTION	IP67	IP67	
OPERATOR WEIGHT	220 N (~22 kg)	220 N (~22 kg)	
DIMENSIONS	see drawing	see drawing	



**DIMENSIONS**

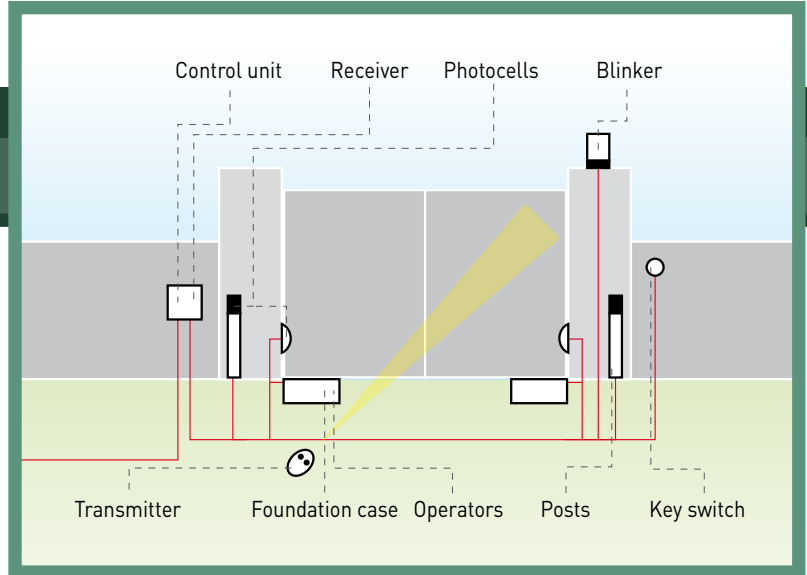
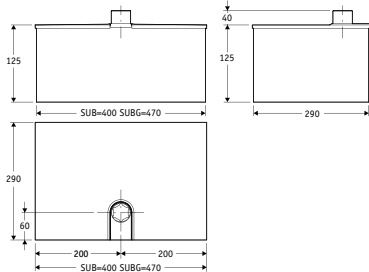

**ACCESSORIES**



**D113706 00002 - ALCOR N**

• Ideal control panel for one or two motors up to 230V/0.5 HP of the swing type. • Easy wiring thanks to extractable terminals

blocks. • Safety thanks to the AUTODIAGNOSIS function with LEDs for detecting faults. • Complete with incorporated two-channel receiver and pedestrian management. • Programming upgraded with the following functions: locked shut maintenance, 3/4 step logic, pedestrian closure, separate opening/closing. • Easy use with previous systems thanks to total compatibility with ALCOR SD.



**D113693 00003 - RIGEL 5**

• Universal control panel suitable for one or two 600W/230V motors (max 600+600W). • Easy to wire also for centralised

connections thanks to extractable terminals and the AUTODIAGNOSIS function. • Safety thanks to control of braking and the motor torque. • Complete with extractable 2-channel receiver, ready for fast coupling to receivers with greater capacity and advanced functions. • Total control of programming by digital display and three simple buttons.



**D113050 - SPL**

Preheating board for 1 or 2 LUX, SUB, ORO, P4,5-P7, BERMA and E5 operator models. With this accessory the operator is able to work at very low temperature.



**D111704 - SSR5**

Traffic light and preheating control board for RIGEL 5 control panel. The operator is able to work at -20° with this accessory.



**P111376 - SCS 1**

Serial connection board for QSC D MA, LIBRA C MA, LIBRA C MV, LIBRA C LX, VENERE D, LEO D MA, LEO MV, RIGEL 5 and ALTAIR P.



**NEW 2008**

**P111408 - SCS WIE**

Circuit board for direct connection of wiegand accessories (such as SELETTO, COMPAS SLIM, etc) to the control units QSC D MA, LIBRA C MA, LIBRA C MV, LIBRA C LX, VENERE D, LEO D MA, LEO MV, RIGEL 5 and ALTAIR P.



**D111013 - ME**

12 Vac electric lock board.



**P123001 00001 - EBP**

230 Vac electric lock with zero stop resistance. Also available in 50 mm, 75 mm versions and at 24V.



**D121017 - ECB SX**

Left-hand horizontal electric lock. Also available in right-hand and vertical versions.



**N733066 00003 - FCS right**

Bearing foundation case for SUB operator fitting. Maintenance can be carried out without disassembling the gate.



**NEW 2008**

**N733066 00004 - FCS left**

Bearing foundation case for SUB operator fitting. Maintenance can be carried out without disassembling the gate.



**N733092 - CPS G**

Bearing foundation case for either left hand or right hand SUB G operator fitting. Maintenance can be carried out without disassembling the gate.



**D610256 - CLS/82**

Release key for SUB model (10-piece pack).



**N728003 - IDROLUX R**

Red hydraulic oil, 2 lt can. Always fill up with oil of the same colour



**N728002 - BSC**

SUB arm outside hinge.